

WATER SPORTS AREA

- 3 Dry Fountain
- 4 Floating Deck
- 7 Hot Air Balloon Station
- 18 Waterfront Steps

RESTAURANT & TERRACE AREA

- 1 Avenue
- 8 Lift
- 10 Planter and Seating
- 11 Restaurant & Cafe
- 18 Waterfront Steps

SCULPTURE DISPLAY AREA

- 1 Avenue
- 4 Floating Deck
- 5 Garden Terrain
- 12 Sculpture Walk
- 15 Water Plant
- 18 Waterfront Steps

MOVIE THEATRE AREA

- 1 Avenue
- 6 Grand Lawn
- 9 Pier Deck
- 10 Planter and Seating
- 14 Water Features
- 16 Water Screen
- 17 Waterfall
- 18 Waterfront Steps

ENTRANCE PLAZA AREA

- 1 Avenue
- 3 Dry Fountain
- 4 Floating Deck
- 10 Planter and Seating
- 15 Water Plant
- 18 Waterfront Steps

GOLDEN BAUHINIA SQUARE AREA

- 2 Bauhinia Sculpture and Flag Pole
- 10 Planter and Seating
- 13 The Monument in Commemoration of the Return of Hong Kong to China
- 18 Waterfront Steps

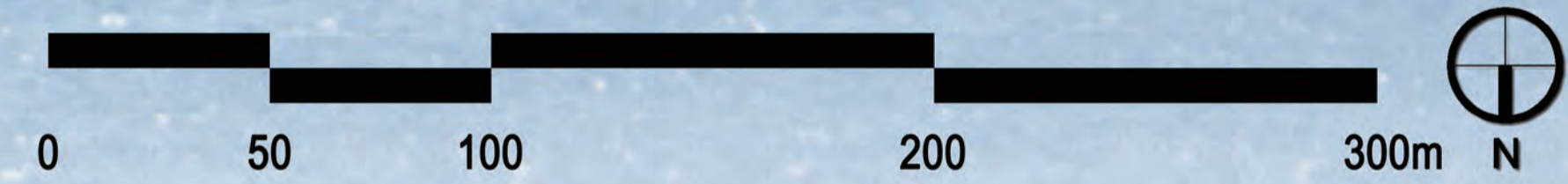

Neo Wan Chai North:
 Bridging the Coast aims to bridging the gap between human and water, creates balanced entertained, relaxed waterfront, and improves our natural ecologies of landscape, water and shore. This scheme promotes a new urban waterfront model that consists of exhibition and commercial.

PROGRAMME NODES

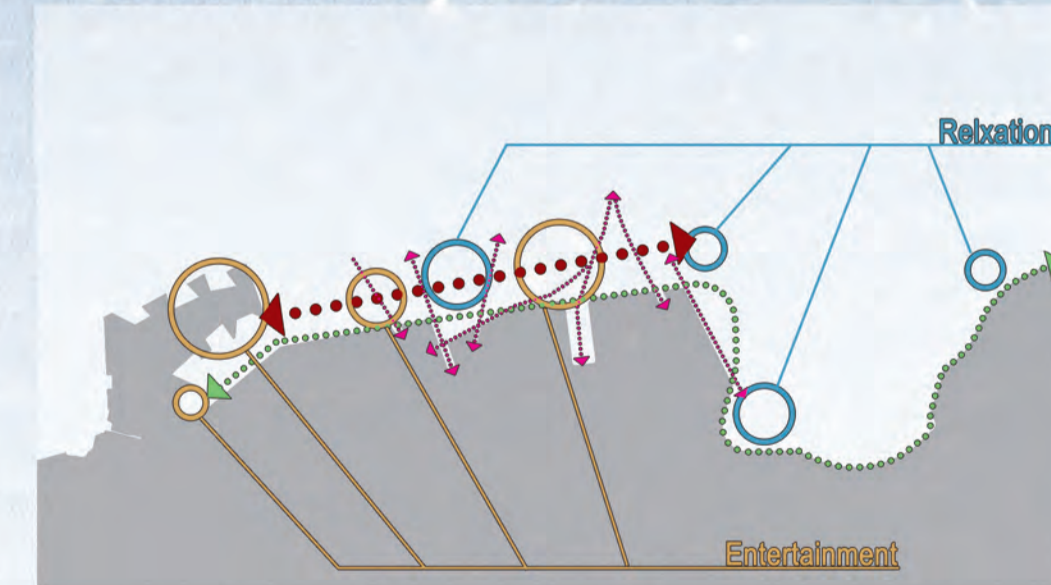

NEO WAN CHAI NORTH : BRIDGING THE COAST

CONNECTIVITY

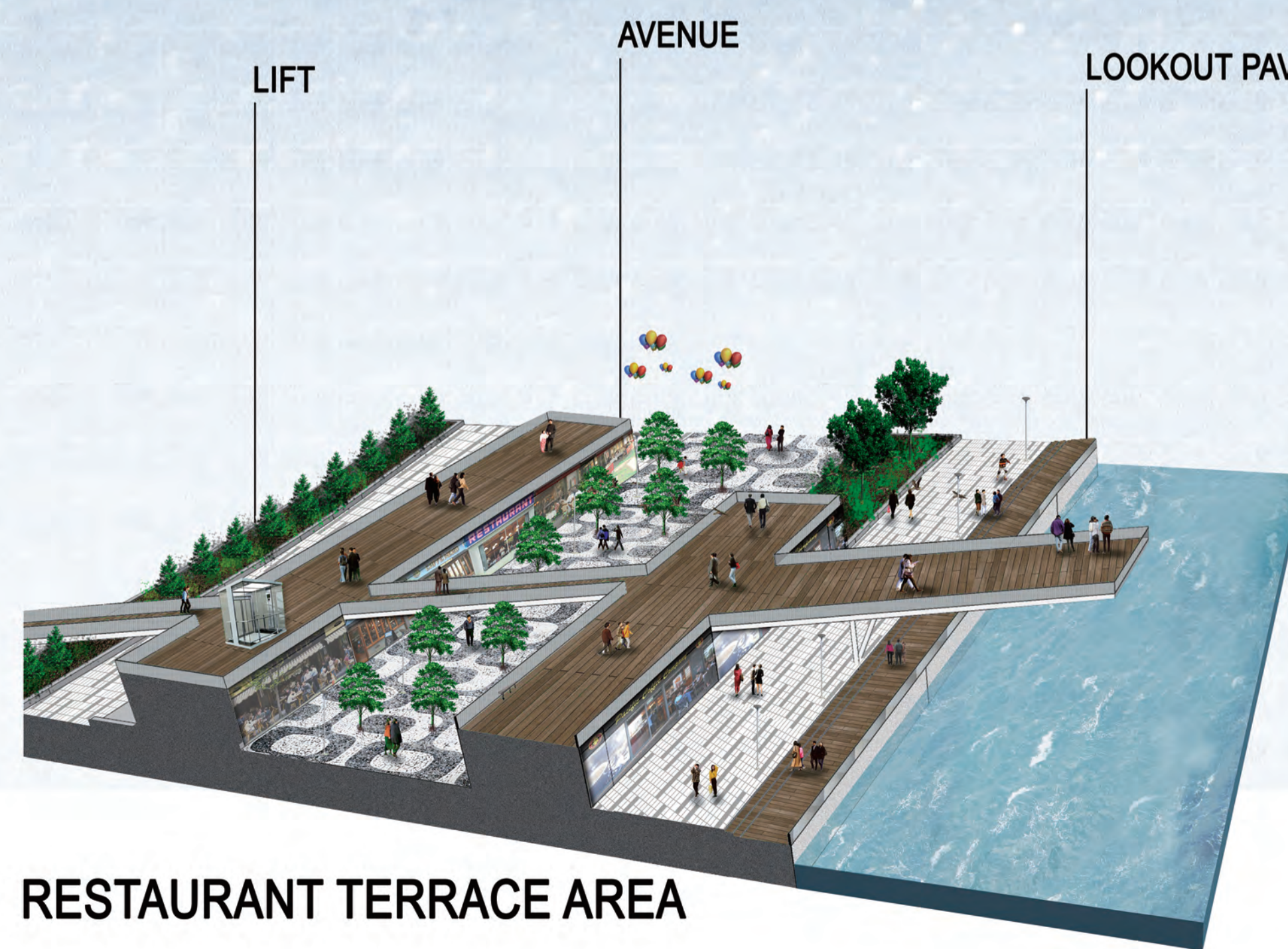
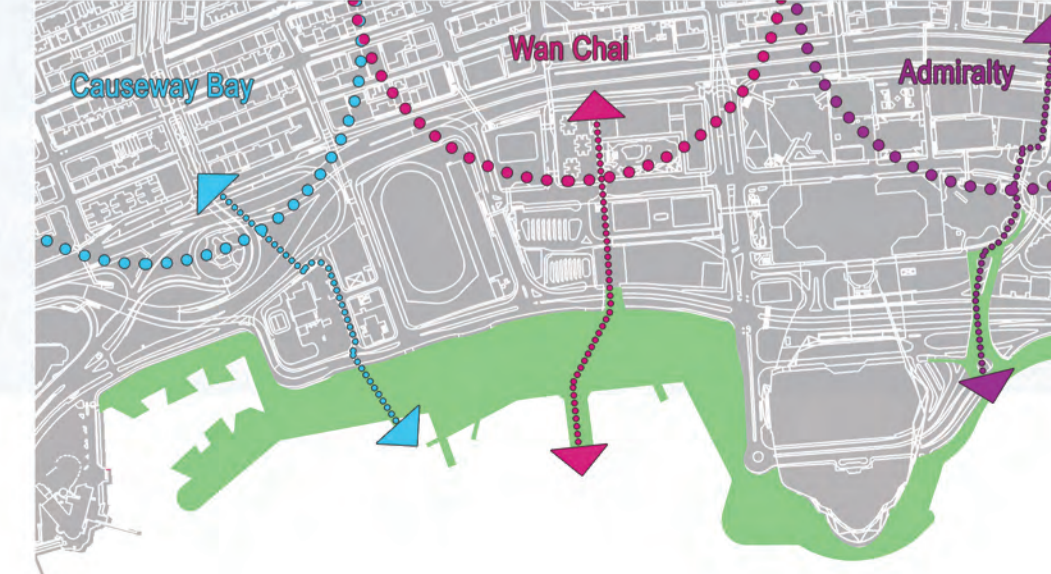

RESTAURANT TERRACE AREA

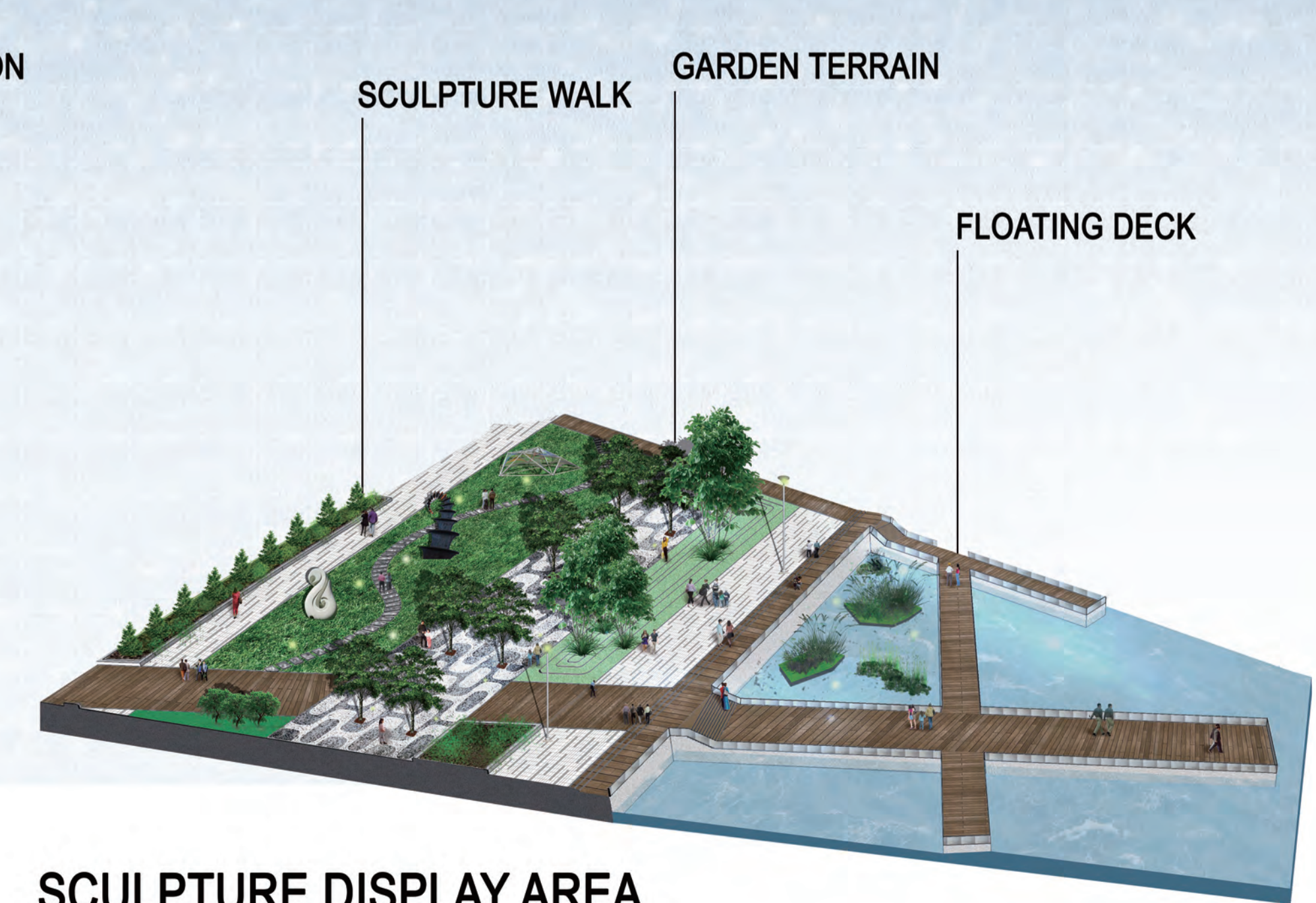

SCULPTURE DISPLAY AREA

